



🇬🇧 20 mm aluminium profiles are available in different length. However it is possible to connect several profiles together without any length limit. Standard color is aluminum, according to the individual request it is available in any RAL color. MAG-Sign profile end caps are black or grey.

🇪🇪 20 mm alumiiniumist profiile on saadaval erinevates pikkustes. Profiile on võimalik omavahel ühendada, mistõttu puudub pikkuse piirang. Standardvärv on alumiinium, kuid profiili on võimalik vastavalt soovile värvida igas RAL värvis. MAG-Sign profiili otsakorki on võimalik valida vastavalt soovile kas musta või halli värvi.

ENDCAPS



Profile includes magnet, plastic wires, endcaps and M3 assembling piece.

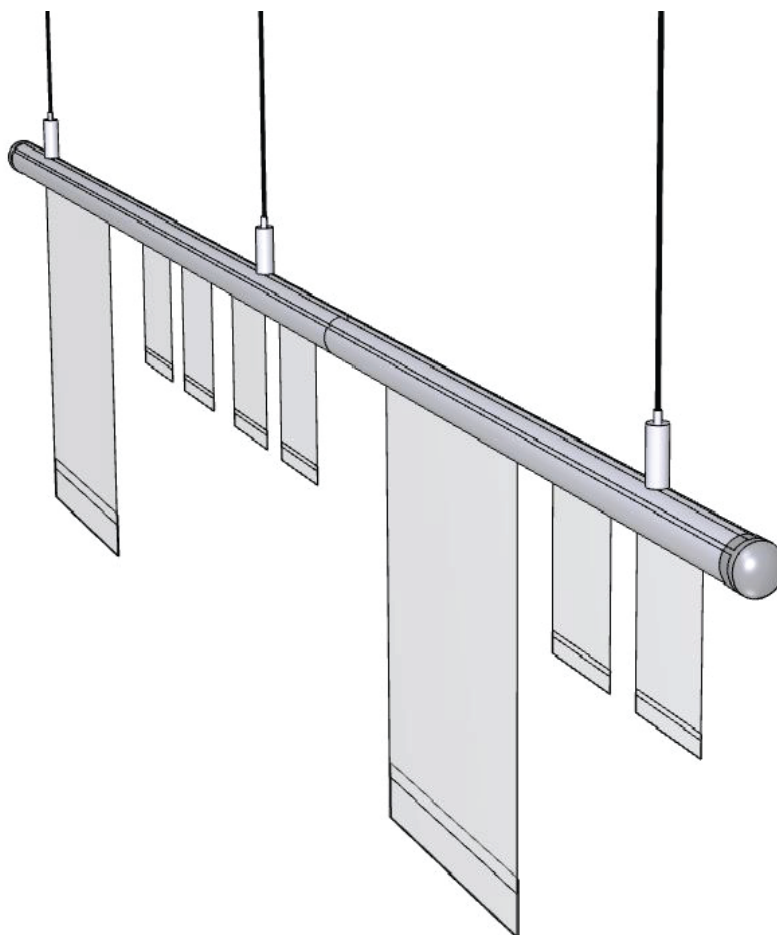

The metal bar or profile does not hide the information on leaflet.

Metallriba taskul ja profiil ei varja infolehel olevat informatsiooni.

Code	Length	Colour	Endcap colour*
S1214-1	100 cm	Aluminium	Black or grey
S1214-2	200 cm	-	-
S1214-3	300 cm	-	-

Within each profile, there are at least 2 assembling pieces in which Quick fix is screwed in. Quick fix is for every 1 m, fixed evenly so that the profile will be horizontally and not at an angle. E.g. for 1 and 2 meters long is needed 2 Quick fix and for 3 m long 3 Quick fix. The height of the profiles can be adjusted comfortably.

Iga profiili sees on plaat, kuhu sisse kruvitakse 1 Quick fix. Quick fix iga 1 m tagant, paiguta koos plaadiga ühtlaste vahedega, et profiil jääks horisontaalselt, mitte kaldu ning kannaks võrdselt. 1-2 m profiilile 2 tk ja 3 m profiilile 3 tk Quick fix'e. Profiilide kõrgust saab mugavalt reguleerida.

1-2 m



3 m

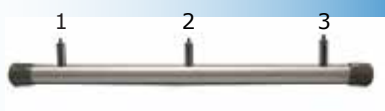

POCKET



Steel cable and clamp



Quick fix



Connecting piece



Fastener 1



Fastener 2

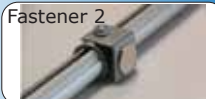

Code	Poster width	Poster height
S1214-A6V	10,5 cm	14,8 cm
S1214-A6H	14,8 cm	10,5 cm
S1214-A5V	14,8 cm	21,0 cm
S1214-A5H	21,0 cm	14,8 cm
S1214-A4V	21,0 cm	29,7 cm
S1214-A4H	29,7 cm	21,0 cm
S1214-A3V	29,7 cm	42,0 cm
S1214-A3H	42,0 cm	29,7 cm
S1214-A2V	42,0 cm	59,4 cm
S1214-A2H	59,4 cm	42,0 cm

Code	Name	Specification
9210476	Quick fix	Load up to 10 kg
9180759	Steel cable	1 mm, 250 m/roll
9180760	Clamps for steel cable	
9180761	Connecting piece*	10 cm
7201	Fastener 1, for shelf	RAL9006
7200	Fastener 2, for wall	RAL9006

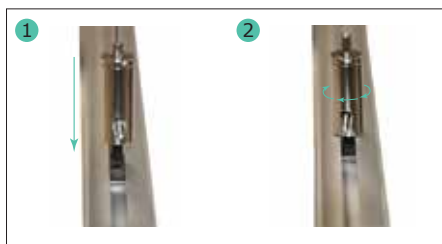

Screw Quick fix into the assembling plate clockwise, by hand. As long as Quick fix is fixed. Make sure that Quick fix will be vertically. Repeat the same with other Quick fixes.

Kruvi Quick fix profiili sees oleva plaadi sisse päripäeva, käsitsi. Nii kaua, kui Quick fix on kinnitunud. Jälgi, et Quick fix oleks plaadi suhtes vertikaalselt. Korda sama ka teiste Quick fix-idega.

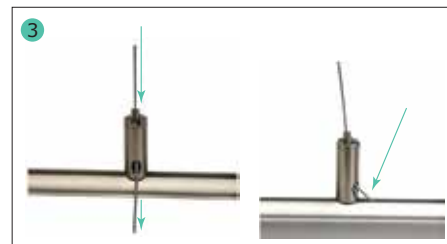
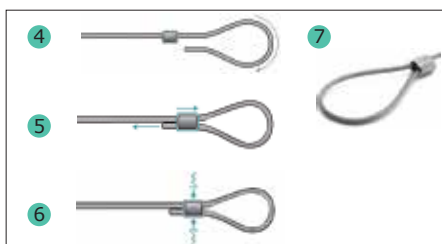

Slide cable end into the Quick fix so that it will be coming out of the hole, on the side. Leave there some reserve, for example, 5 cm. Hide the cable in.

Lükka üks trossi ots Quick fix-i ülemisest otsast sisse nii, et see küljel olevast august välja tuleks. Jäta sinna mõningane varu, nt 5 cm. Peida trossi ots profiili sisse.

Cut the cable to the appropriate length (+ some extra), with the pliers. Pull the cable through the clamp as a loop and fasten the clamp with a plier. Attach the profile to the ceiling with the cable.

Lõika tangidega tross sobivaks pikkuseks (+ mõningane varu.) Vii trossi ots aasana läbi klambri ja kinnita klamber näpitauga. Kinnita profiil aasa abil lakke.

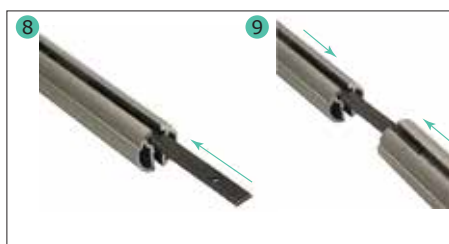

Connect profiles*. Slide connecting piece halfway into the profile (if the profile has a cap, then remove it first) and connect other profile so that connecting plate is going inside of it freely. Fix the connecting plate with two screws so the screw will go through the threaded hole on the connecting plate. Use M3 9 mm screws. The profiles should stick firmly, tighten the screws if necessary.

Profiilide omavahel ühendamiseks*.

Libista ühendusplaat poolenisti profiili sisse (kui profiilil on otsakork, siis eemalda esmalt see) ja tõsta teine profiil selle külge nii, et ühendusplaat läheks profiili sisse vabalt. Kinnita ühendusplaat kahe kruviga nii, et kruvi läbiks ühendusplaadil olevat keermeava. Kasuta M3 9 mm kruve. Profiilid peaksid jääma jäigalt kinni, vajadusel pingulda kruve.

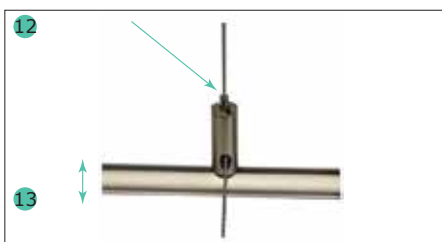

To adjust the height of the profile, press the button on the Quick fix and move the profile up or down, to get suitable height. Make sure the cable won't come out of the Quick fix.

Profiili kõrguse reguleerimiseks vajuta Quick fix-il olevat nuppu ja liiguta profiili üles või alla. Jälgi, et tross täielikult Quick fix-ist välja ei tuleks.

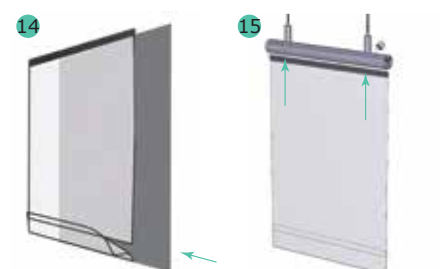

Slide poster into the PVC pocket. PVC pocket metal clip-strip attaches to the magnet on the bottom of the profile. To remove the pocket - hold the pocket from the top corner and pull it down. Do not pull the pocket straight down.

Libista reklaamleht PVC taskusse. PVC tasku kinnitub profiili alumisel küljel oleva magneti külge. Tasku eemaldamiseks - võta tasku ülemisest nurgast kinni ja tõmba alla. Ära tõmba taskut otse alla.